

Ring back test

The ring back test can confirm the link with the connected phone as well as the Caller ID feature (if supported) and the current ring style. If possible you should also test by making calls to, and receiving calls from another phone.

- 1 Lift the handset and dial ***9#**
- 2 Replace the handset. The attached phone should ring (for 30 seconds).

If the phone supports Caller ID, the display should show the number '01234567890' and the message 'Test Call'.

Making calls

- 1 Lift the handset and listen for a dial tone.
If you hear a series of short tones, the T350 terminal is either waiting for a PIN code (see 'Enter a PIN code' overleaf) or no SIM card is installed.
- 2 Dial the required number and then press the **#** key to place the call.

If you do not dial #, the call will be placed automatically three seconds after the last button is pressed. You can adjust the delay period (see 'Dial delay' within the full user guide for details).

Receiving calls

- When the phone rings, lift the handset and take the call in the normal way.
If the caller's number is made available by the network, and the attached phone supports Caller ID, it will be shown on the display of the phone.

Status Indicators

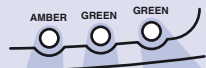

AMBER GREEN (POWER STATUS)



Initialising/searching

Standby - ready for use

Waiting for PIN code

The amber and centre green indicators provide status information by flashing on and off in various ways. Each complete circle below represents 2 seconds and the shaded portions show the period that each indicator is on.

AMBER GREEN



Weak signal

Battery low, please wait

Fault

This quick start guide will help you to set up, switch on and begin using your T350 fixed cellular terminal. For further information, please refer to the full user guide supplied with the product.

Setting up

Remove the cover

Place the T350 terminal on a level surface. Grip the ridges on either side of the light-grey top cover and lift it gently from the base unit. This will reveal the SIM card holder and the battery.

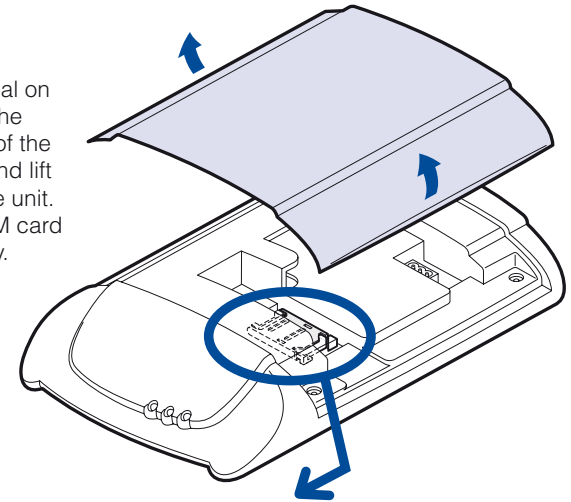

Install your SIM card

Note: Ensure the T350 is switched off (see inside) before installing a SIM card.

- 1 (a) Slide back the hinged lid to unlock it, then (b) swing it open.

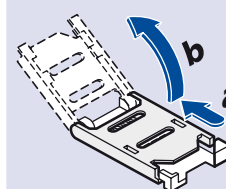

- 2 (a) Insert the SIM card into the hinged lid as shown.

(b) Swing shut the hinged lid ensuring that the SIM card remains fully in place.

- 3 Press down upon the hinged lid and slide it across so that it locks into place.

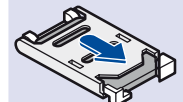

Connect the battery

Your T350 terminal may have been shipped with its battery disconnected. If so, locate the battery lead and plug it gently but firmly into the adjacent socket (it will fit one way only).

You can now replace the light-grey top cover.

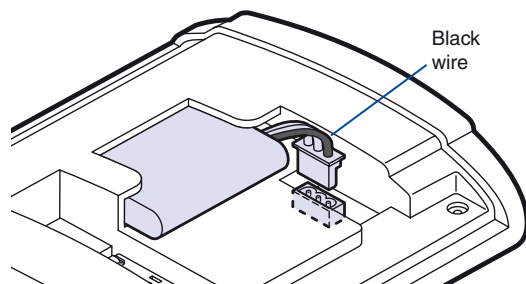

Place your T350 terminal in a suitable location, but keep it at least one metre from your telephone to avoid interference. If the signal strength is insufficient, you may need to adjust the position of the antenna (see below).

Connect the antenna

- 1 Align the supplied antenna (or another suitable GSM antenna) with the circular connector on the far left of the rear panel.
- 2 Attach the antenna and twist the connector collar clockwise until it is finger-tight - do not over-tighten.
- 3 In use, the antenna should always be vertical. The supplied antenna has a hinge so that you can position it correctly. When the unit is wall mounted the antenna should point straight down.

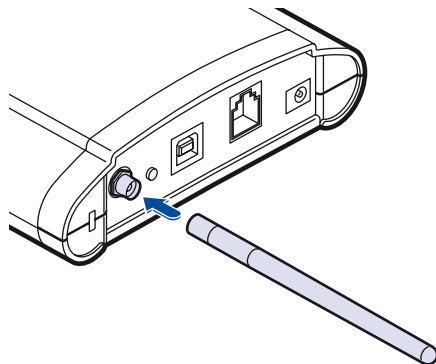

Connect a telephone

- 1 Connect a standard corded telephone to the socket on the rear panel. If your phone has a different connector than a standard RJ11 type, use an adaptor (supplied in some kits).

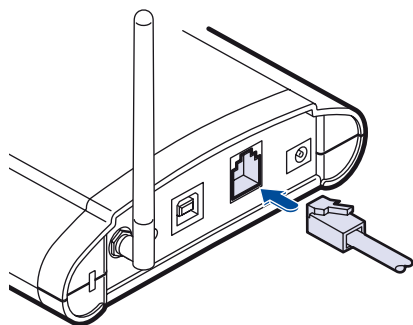

Connect power

- 1 Attach the connector from the power adapter to the socket on the far right of the rear panel.
- 2 Plug the power adapter main body into a nearby mains outlet. The right hand green indicator on the front panel will light to show when power is supplied.

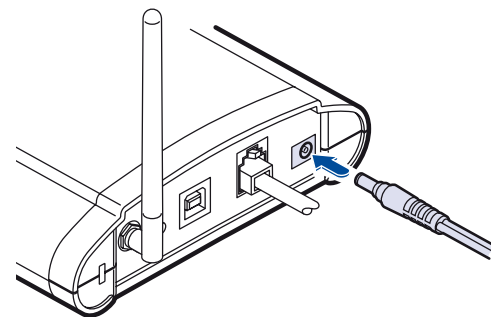

Switch on



On the T350 terminal rear panel, press and hold the red button until the front panel amber and centre green indicators illuminate, then release the button.

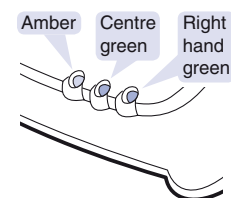

The centre green indicator will show a rapid on/off flash while the T350 terminal initialises itself (approx 15 secs).

When the initialisation is complete, the T350 terminal will do one of two things:

Centre green indicator extinguishes and amber indicator shows a rapid on/off flash.

This indicates that a PIN code is required to unlock the SIM card.

Centre green indicator changes to a short flash every two seconds.

This is the 'standby' flash and shows that the T350 terminal is ready for use. Please see the rear page for further details.

Enter a PIN code

- 1 Lift the handset (you will hear a series of short tones instead of a dial tone).
- 2 On the telephone keypad, dial the following:

***8* [PIN code] #** where [PIN code] is a valid 4-digit code for the SIM card.

- If the code is accepted: You will hear two short beeps, the amber indicator will extinguish and the centre green indicator will show a short 'standby' flash every two seconds. The T350 terminal is now ready for use, please see the rear page for details about making and receiving calls.
- If the code is rejected: You will hear a single low pitched beep. Check that you have the correct PIN code for the SIM card in use, replace the handset and then try again. *Note: If you enter an incorrect PIN code three times, the SIM card will lock and you will need to get a special unblocking (PUK) code.*

To switch off Press & hold the red button until indicators illuminate, then release.